

PXW95 (9 Watts)

Ø95mm 4-Colour LED
Fountain Luminaire, with on-
board current regulation.



- Ideal for use in fountains & water features
- High output, low profile
- Low voltage, high efficiency
- Long life - 50,000hrs typical
- High reliability, low maintenance
- Parallel wiring for ease of installation
- Choice of Stainless Steel and Aluminium housings



Description

LED fountain luminaire fitted with 4 x high power LEDs. Constructed from a high performance, precision machined body with a toughened clear glass lens and a choice of viewing angles using 7°, 14°, 28°, 47°, elliptical or angled output optics. Terminated with a 5 metre cable (other lengths available) via an IP68 cable gland. This LED unit incorporates an on-board "Linear" regulation circuit, allowing the unit to be wired in parallel to a constant voltage power supply.

Characteristics

Optical

Number of LEDs = 4 x high power LEDs
(1 each Red, Green, Blue and Mid White)
Illuminated Area = Ø67.8mm

Optic = Ledil "Heidi"

LED Details

Colour	Wavelength	Lumens
Red	630nm	63
Green	520nm	110
Blue	460nm	30
Colour	CCT	Lumens
Mid White	4000K	125

Electrical

Operating Voltage = 7 - 9VDC
Current = 322mA per colour
Power Consumption = 9W max
Above data is for njo P971.PCB
Termination = 5 metre, 5-core, 0.5mm² CSA, 6.6mm
OD Cable (njo Ref. No. W504)
Luminaire Classification = Class III
(In accordance with BSEN 60598-1:2008)

Mechanical

Bezel O.D. = Ø95.0mm
Lens = 4.0mm toughened glass
Lens Diameter = Ø67.8mm
IP Rating = IP67/IP68
Product Weight = 1.5kg Stainless Steel
1.0kg Aluminium
Mounting Location =
"SS" type = Underwater (IP68)
"BA" type = Out of water (IP67)

Selection Guide

PXW95-	SS-	RGBMW-	MA-	C-	7-	5M
Product Series	Housing	LED Colour	Output Angle	Lens Type	Voltage	Cable Length
PXW95 = Fountain luminaire with on-board regulation	BA = Stainless Steel Bezel, Black Anodised Aluminium Body SS = Stainless Steel Bezel & Body	R = Red G = Green B = Blue CW = Cool White MW = Mid White WW = Warm White	ENA = Extra Narrow 7° NA = Narrow 14° MA = Medium 28° WA = Wide 47° EL = Elliptical 47° x 8° AO = Angled Output	C = Clear	7 = 7VDC (typical)	5m = 5 metre cable

Example PXW95-SS-RGBMW-MA-C-7-5M (PXW95, Stainless Steel, Red, Green, Blue and Mid White LEDs, Medium Output Angle, Clear glass Lens, 7VDC, 5 Metre Cable)

PXW95 (9 Watts)

Ø95mm 4-Colour LED
Fountain Luminaire, with on-
board current regulation.



Mechanical Details

Side View

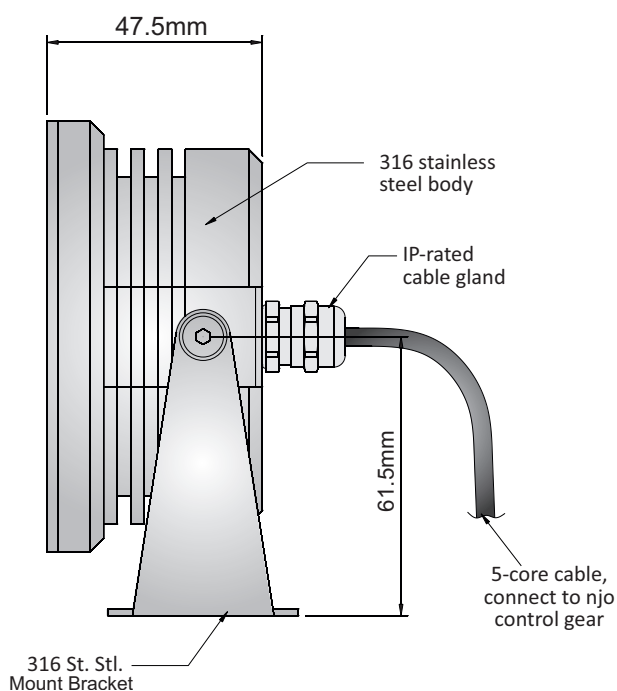

Front View

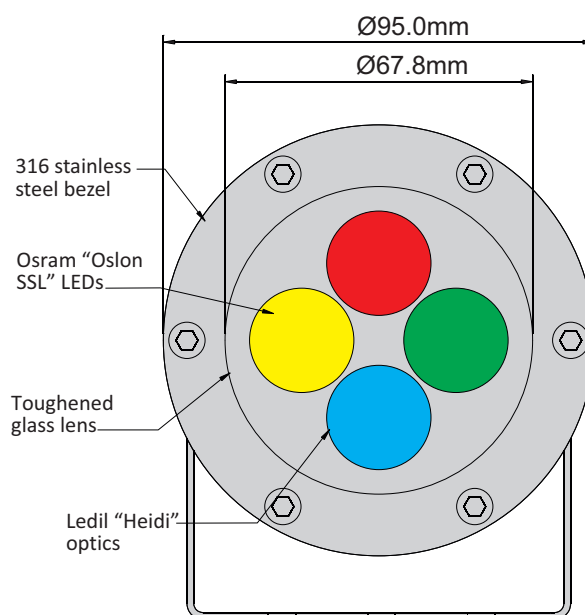

Bracket Fixing Detail

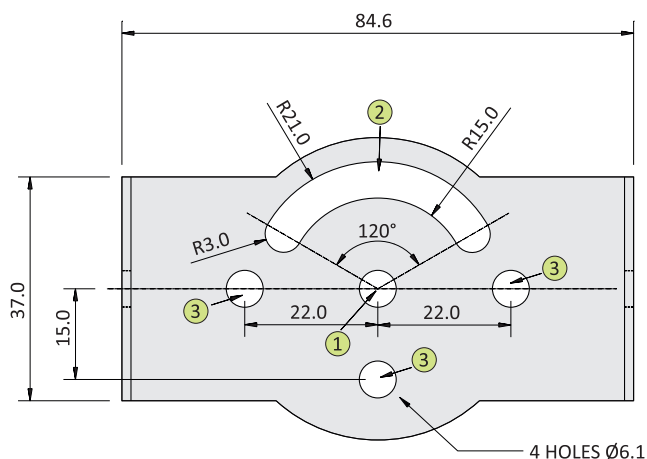

1) Fasten bracket to your desired mounting surface with 1 screw through hole 1 on the bracket - do not fully tighten yet.

2) Fix a screw through the centre of slot 2 - do not fully tighten yet.

This will now allow rotational adjustment if required. Once the bracket is in the desired position, the fixings can be tightened.

3) If the rotational adjustment is not required the bracket can be fixed via the 2 outer holes along the centre of the bracket.

If additional strength is required screws can be fixed through the remaining positions (holes 3).

The appearance and specifications of the product may be modified for improvement without notice.